



34 Purtell Street BENTLEIGH EAST, VIC

3 1 3

## Timeless Art Deco with far-reaching appeal (Approved Townhouse Plans & Permits)

Evocative curved walls and windows, captivating geometric ceiling panels and a classic porthole front door are tell-tale signs of a glamorous bygone era - and they are all on full display at this timeless and potential-rich Art Deco home.

Ready and waiting to have its interiors reimagined for modern-day family living, the home is nestled on a substantial site of approximately 670sqm which will also prove tempting to savvy developers thanks to its size and approved plans & permits for two luxury townhouses.

Renovate/extend the current floorplan, take advantage of the existing plans and permits for two town residences or bring your own vision to the site and craft an incredible, brand new family sensation of your own design (STCA).

**\$1,535,000 - \$1,650,000**

**Type** : House  
**Sold Date** : Saturday, 21st August 2021  
**Land** : 670 m2



**Con Nicolis**

0416271411

# 34 Purtell St, Bentleigh East

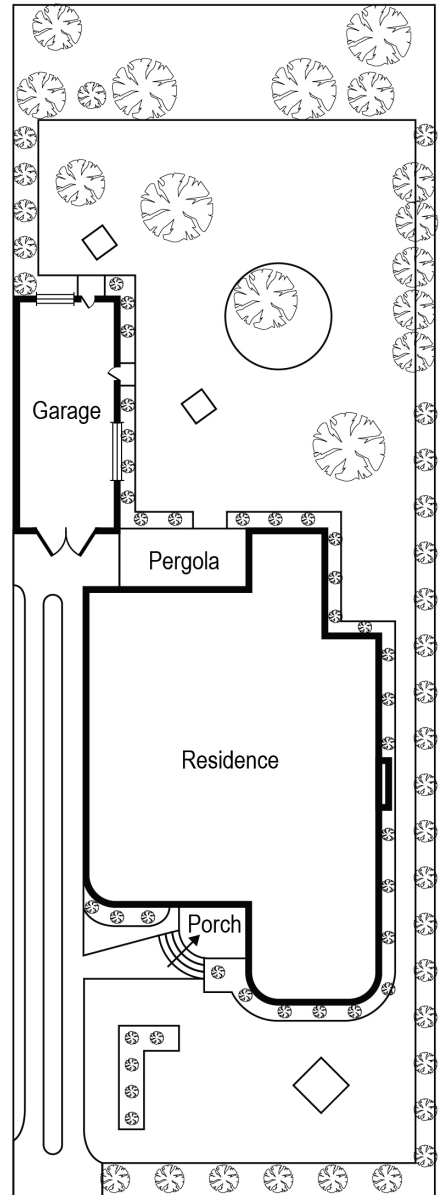
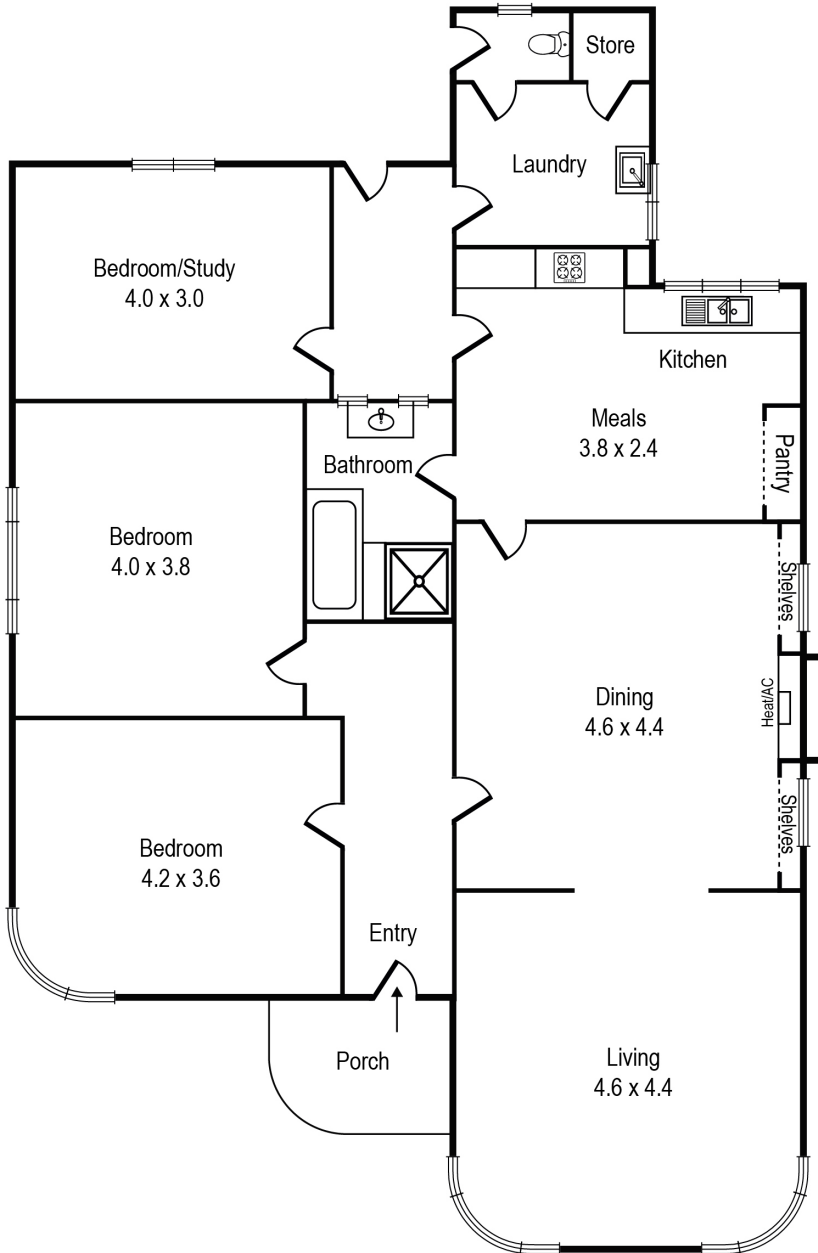

Whilst every attempt has been made to ensure the accuracy of this floorplan, measurements of doors, windows, rooms and any other items are approximates only. The producer or agent cannot be held responsible for any errors, omissions or misstatements. This plan is for illustrative purposes only and should be used as such.